

**AMERICAN COOLER TECHNOLOGIES****INSTALLATION INSTRUCTIONS FOR  
COOLER/FREEZERS WITH STANDARD FLOOR****NSF INSTALLATION GUIDE****PLEASE READ CAREFULLY BEFORE PROCEEDING WITH INSTALLATION**

All ACT Projects are shipped complete with detailed drawings indicating location of floors, walls, tops and interior partitions.

All sections are numbered at the factory and will correspond with the identification numbers indicated on the detail drawings.

**FOR PROPER SET-UP DO NOT  
DEVIATE FROM THIS NUMBERING SYSTEM****FOR NSF LISTED PRODUCT DO NOT DEVIATE FROM  
INSTALLATION INSTRUCTIONS****INFORMATION INCLUDED IN THIS PACKAGE**

- 1. Cover Page
- 2. Detail Drawings for Locating Floors, Walls & Tops
- 3. Floor Installation Details
- 4. Wall Section Installation Details
- 5. Top Section & Trim Cap Installation Details
- 6. Door Jamb & Bracket Installation Details
- 7 & 8. Other Sheets

**American Cooler Technologies**

900 Crandall Parkway  
Lawrence, MI 49064  
Phone: (269) 674-8144  
Fax: (269) 674-3561

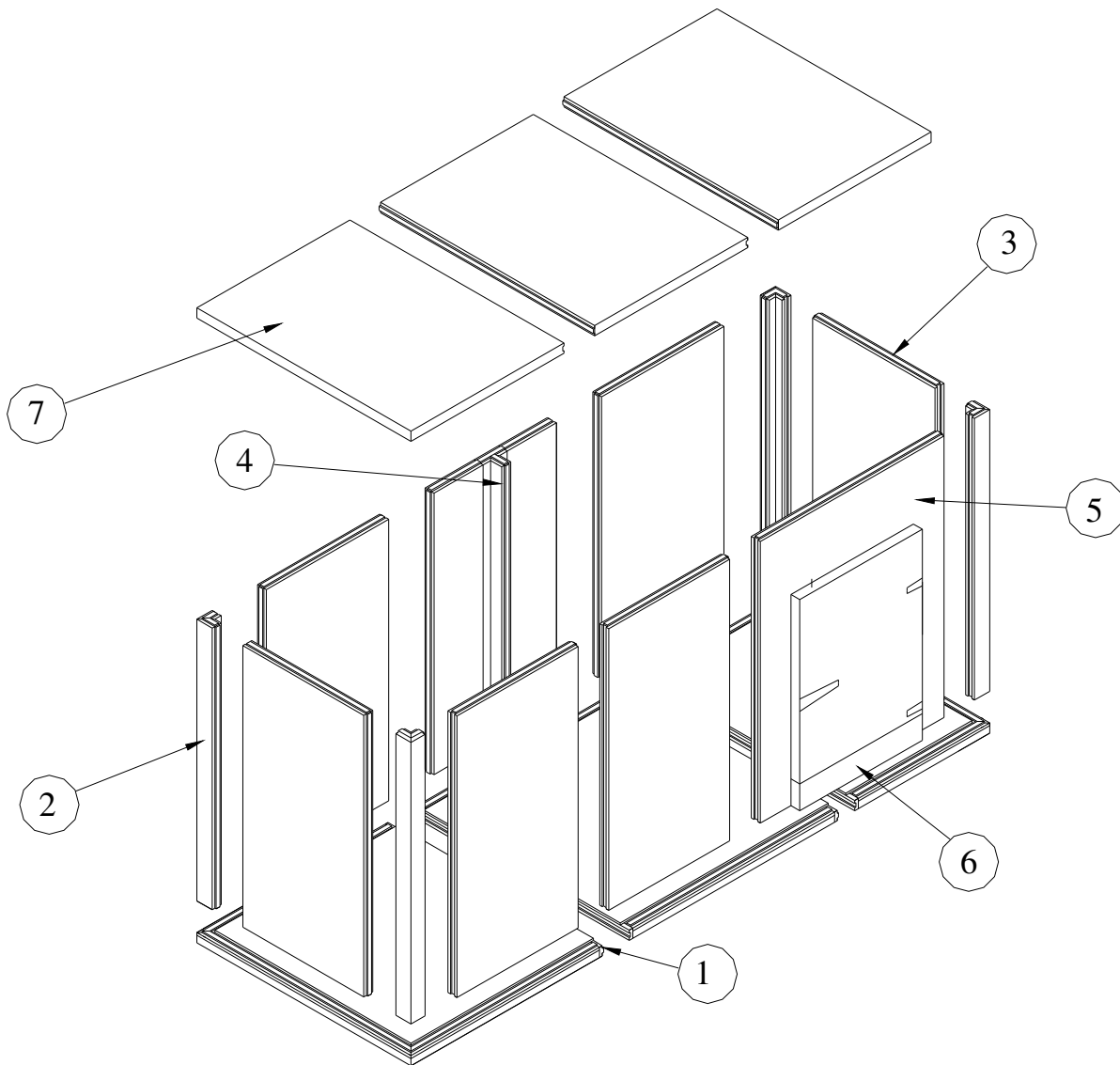

1. COMPLETE FLOOR
2. 6" CORNER
3. WALL SECTIONS

4. "T" CORNER
5. DOOR SECTION
6. DOOR
7. TOP SECTION

**NOTE:**

- \* SEAMS BETWEEN TREAD PLATING SHALL BE SEALED USING NSF APPROVED SILICONE SEALANT.
- \* PERMANENT JOINTS AND SEAMS SHALL BE SEALED AND SMOOTH USING NSF APPROVED SILICONE SEALANT.

**American Cooler Technologies**

900 Crandall Parkway  
Lawrence, MI 49064  
Phone: (269) 674-8144  
Fax: (269) 674-3561

## FLOOR INSTALLATION INSTRUCTIONS

Each floor is numbered at the factory. Following the detail drawing, place the corresponding floors in the correct position as indicated on the layout. Do not deviate.

1. Make sure floors are level and shim as required. Leave at least a 1" air gap around the floor between them and any other existing walls. Caulk between male rail of floor & female rail of wall with sealer to ensure a good seal.

**NOTE: FOR PROPER COOLER INSTALLATION IT IS MANDATORY THAT THE FLOORS ARE LEVEL & SQUARE!**

**STOP: YOU ARE NOW READY TO INSTALL WALL & CORNER SECTIONS.**

2. Check floor layout dimensions for accuracy. If the floor is square and level, then proceed to install wall sections as indicated on Wall Installation Instruction Sheet.

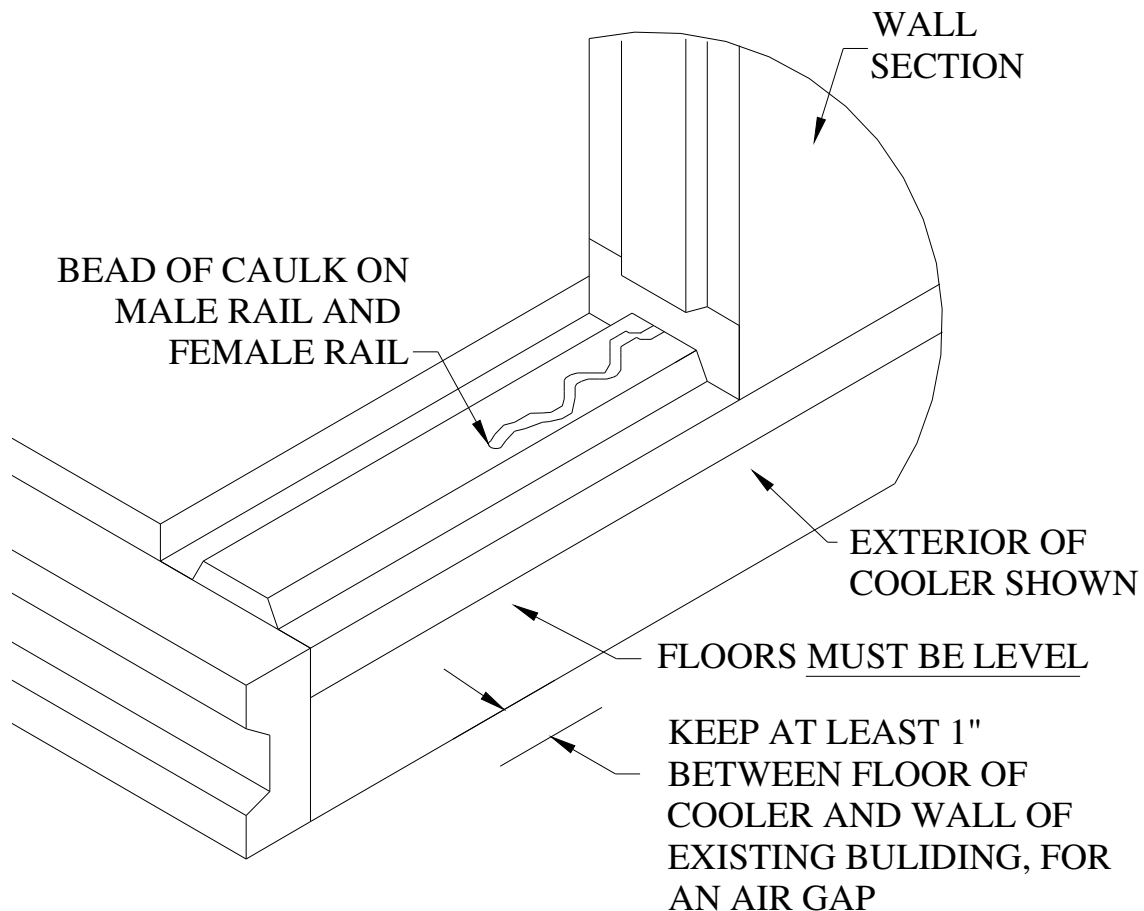

### American Cooler Technologies

900 Crandall Parkway  
Lawrence, MI 49064  
Phone: (269) 674-8144  
Fax: (269) 674-3561

## WALL INSTALLATION INSTRUCTIONS

**NOTE: IF FLOORS ARE LEVEL AND SQUARE, WALL SECTIONS CAN BE INSTALLED FAST AND TROUBLE FREE.**

1. Start erecting walls in a corner, which could be inaccessible when placing the last section. Refer to the detailed drawing and match the numbers locating the sections with the numbers on the wall panels and install in both directions.
2. Before locking the section together check the metal on the inside at the top. Sections must be level & plumb in both directions. Shim if necessary.
3. When sections are level, lock together using Allen wrench supplied.

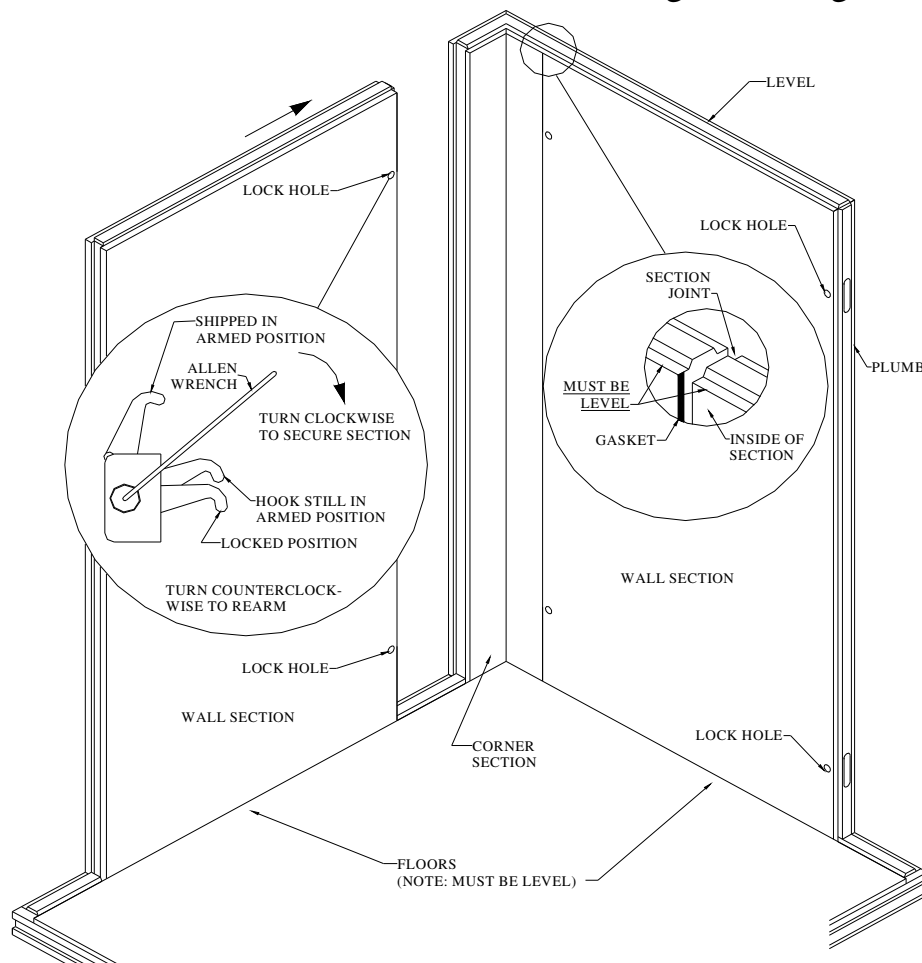

Insert wrench in cam lock hole. Rotate wrench clockwise until hook is in the locked position. If hook fails to engage pin, it must be armed. (See drawing below) Finish installing walls at any accessible corner. Insert lock hole plugs supplied.

### American Cooler Technologies

900 Crandall Parkway  
Lawrence, MI 49064  
Phone: (269) 674-8144  
Fax: (269) 674-3561

## TOP CAP & TOP CAP TRIM INSTALLATION INSTRUCTIONS

1. Start at an end and install tops as numbered and indicated on the detailed drawing provided. Numbers must correspond for a correct installation. Deviations could result in an incorrect joint location.
2. After tops are all in place and pressed firmly to the wall sections, install the hold down lags, 3/8" x 5" supplied. Tops are all pre-drilled at the factory and a lag **must be used in each hole.**

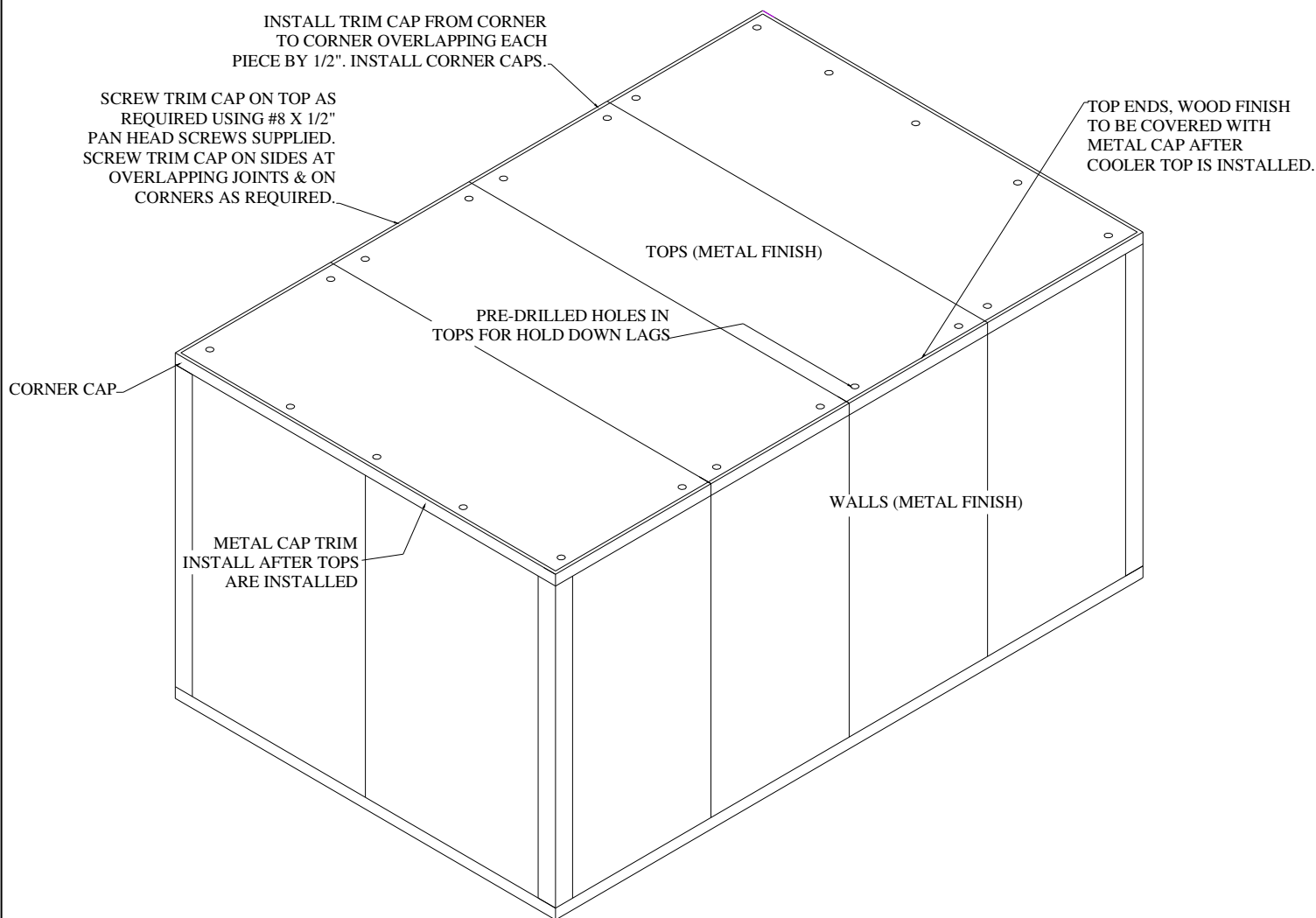

### American Cooler Technologies

900 Crandall Parkway  
Lawrence, MI 49064  
Phone: (269) 674-8144  
Fax: (269) 674-3561

## DOOR INSTALLATION INSTRUCTIONS

1. After floor sections are in place, begin installing corners & walls. When you get to the door section, it simply installs similar to the walls and corners.

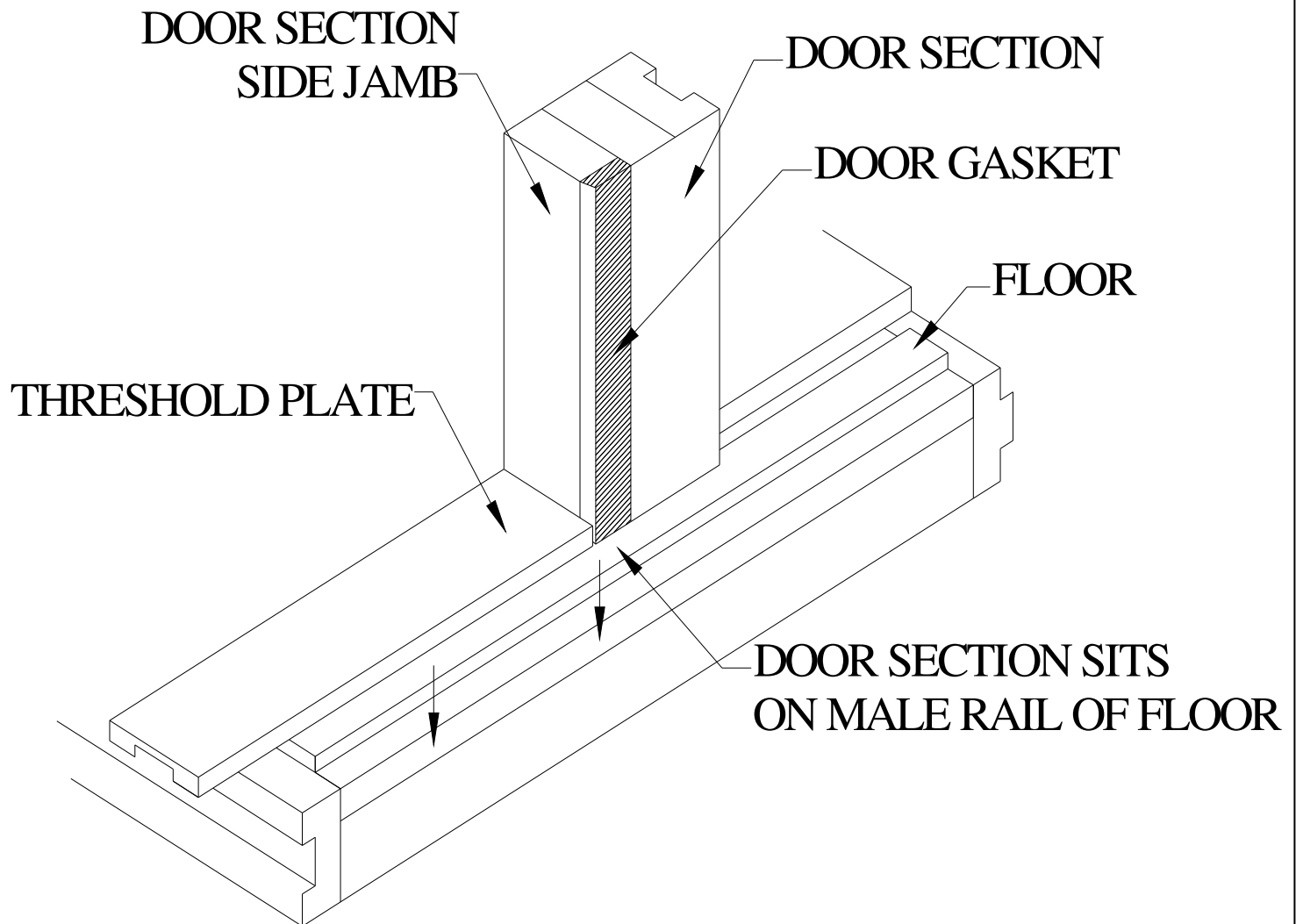

### American Cooler Technologies

900 Crandall Parkway  
Lawrence, MI 49064  
Phone: (269) 674-8144  
Fax: (269) 674-3561

## TOP CAP TRIM INSTALLATION INSTRUCTIONS

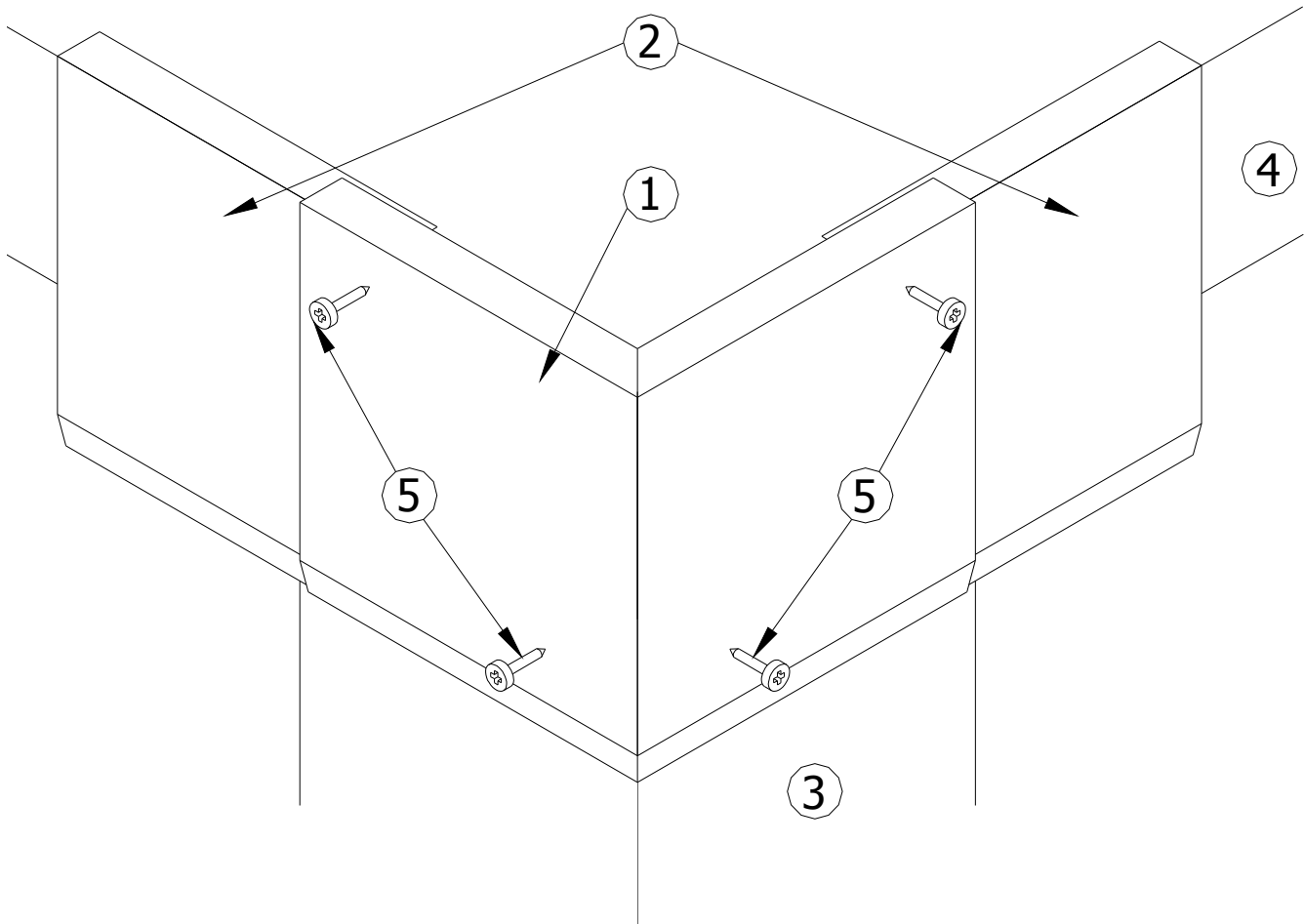

1. Corner piece cap trim. This attaches to the corner to cover the ends of the other cap trim.
2. Cap trim pieces used to cover any exposed wood.
3. Walls that the tops will sit on.
4. 3 1/2" Top
5. Use the 8-18 x 5/8 pan phil tex zinc screws provided by ACT to secure the top trim. 4 screws per corner cap. In the other top trim place screws approximately in the middle of the trim when fastening. Space screws every two feet.

### American Cooler Technologies

900 Crandall Parkway  
 Lawrence, MI 49064  
 Phone: (269) 674-8144  
 Fax: (269) 674-3561

## FLOOR TRIM INSTALLATION INSTRUCTIONS STANDARD FLOOR

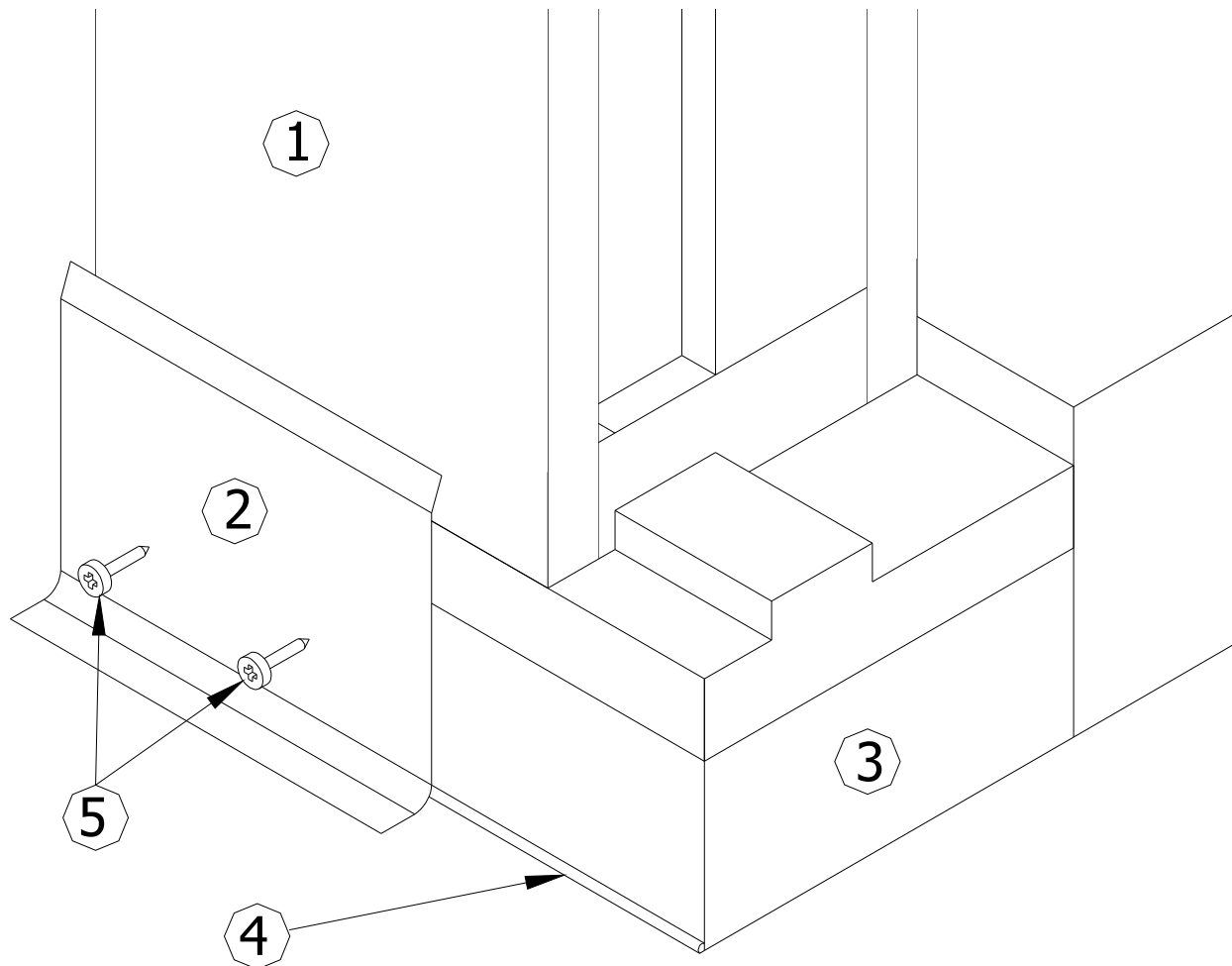

1. Wall that sits on the male rail of the floor.
2. Floor trim, provided by ACT, which covers the exposed wood of the floor. Finish matches the exterior wall finish.
3. Standard 3 1/2" floor.
4. Run a bead of caulk/sealant to ensure no water/liquid gets under the floor. Do this before securing floor trim to the cooler/freezer.
5. Use the 8-18 x 5/8 pan phil tex zinc screws provided by ACT to secure the floor trim. Place screws approximately in the middle of the trim when fastening. Space out screws every two feet.

### American Cooler Technologies

900 Crandall Parkway  
Lawrence, MI 49064  
Phone: (269) 674-8144  
Fax: (269) 674-3561